

# Creating a Profile

## Step 1

Click on the link below and log in using your JustGo log in details  
[JustGo sign in page](#)

## Step 2

On logging in you will be brought to your profile page. Add Family Member box shown circled in red in the image below.

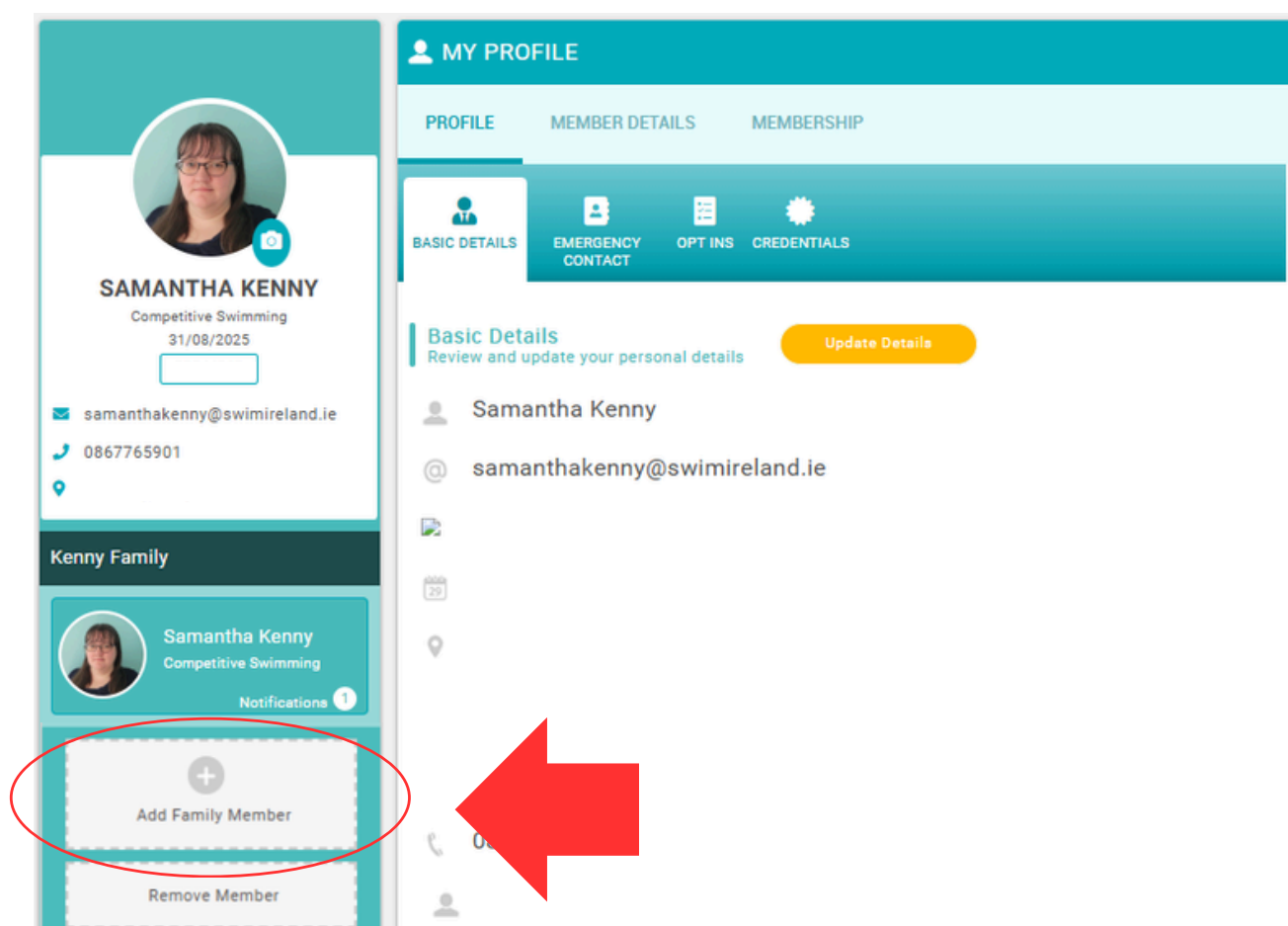

# Creating a Profile

## Step 3

A pop up window will appear in the middle of the screen. Select the New member option shown circled in red in the image below.

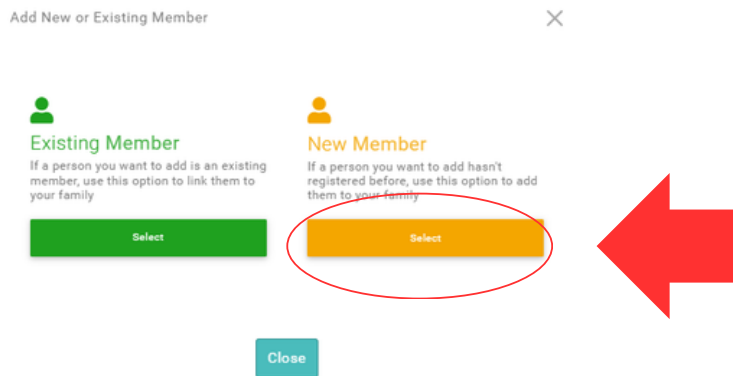

## Step 4

A side bar menu will appear on the righthand side of the screen. Fill in the details of the person you wish to create the profile for and click the continue button as shown circled in red in the image below.

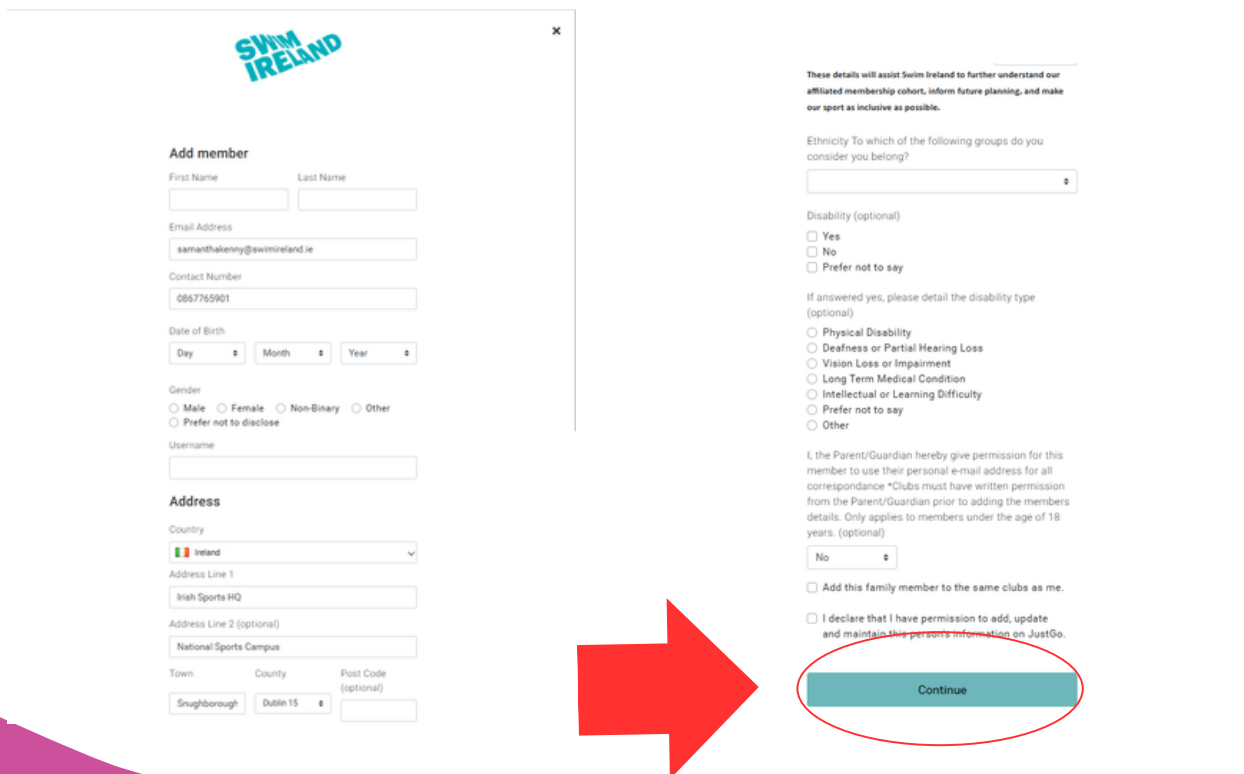

## Step 5

A message will now appear stating that the new profile has been created and added to your family group.

If you wish to create another profile for another family member, please click on the add another member button shown circled in red in the image below.

Otherwise click the Close button shown by the orange arrow in the image below.

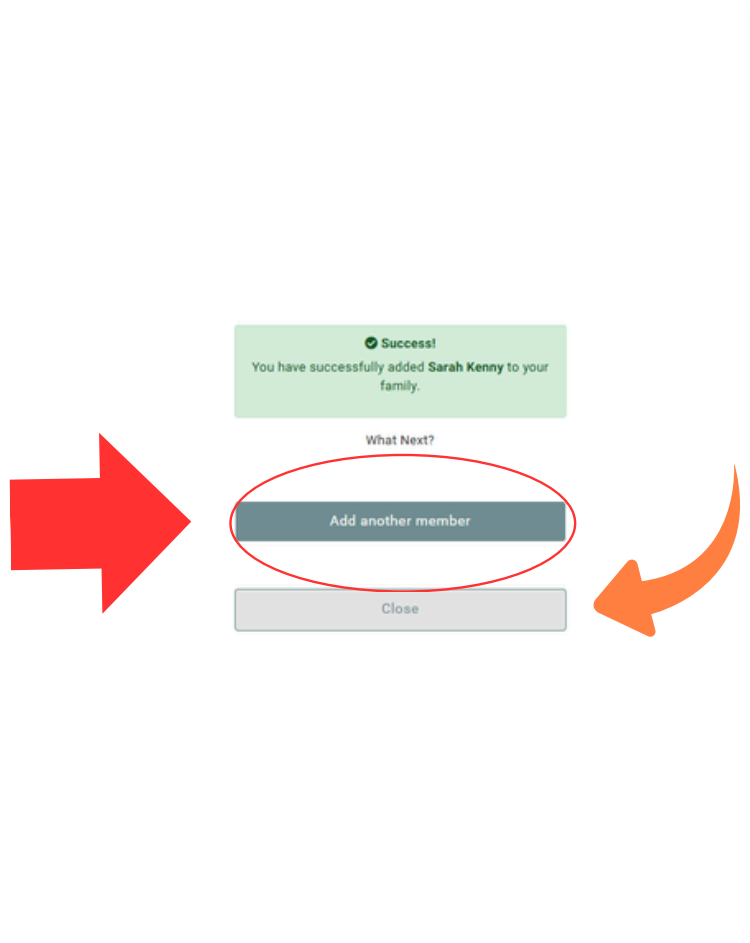

Congratulations you have now created a new profile for your family member.